

Financial Report

Income		Expenditures	
Adult Budget	\$272,803.00	Professional Salaries & Benefits	\$152,472.41
*Capital Campaign	\$154,635.08	Diocesan Taxa	\$49,969.00
Farm Rental income (Schmedding Farm)	\$50,125.00	Debt Repayment (Residence Renovation)	\$27,526.11
Fund Raising Events (Parish Auction)	\$37,255.00	Diocesan Self-Insurance	\$20,089.89
Christmas & Easter	\$24,616.60	Utilities	\$19,557.54
Religious Education	\$18,539.38	Priest Salary /Health Insurance/Pension	\$19,105.00
Social Justice	\$6,450.40	Religious Education	\$18,560.47
Special Campaign, Join-us-from-home	\$5,050.00	Repair/Replacement/maintenance	\$18,425.23
Facility Upkeep	\$4,942.43	Social Justice & Outreach	\$14,670.59
Holy Days & Offertory	\$4,675.41	Payroll Taxes	\$12,594.70
Fuel/AC Contributions	\$4,135.00	Farm Expenses	\$8,474.34
Miscellaneous	\$3,370.29	Liturgical Expenses	\$7,552.84
Interest Dividends	\$2,001.82	Office & Administration	\$7,187.91
Memorials & Sacramental Offerings	\$1,458.00	Technology & Innovation (Join-us-from-home)	\$4,602.79
Stole Fees	\$1,355.00	Resident Upkeep	\$3,728.94
Snow Removal	\$1,105.00	Miscellaneous Expenses	\$1,313.67
Holiday Flowers	\$575.00	Memorials	\$615.00
Rental of Facilities	\$150.00	Interest on Construction Loan	\$588.47
Funeral Supply Contribution	\$75.00	Parish Auction	\$284.50
Total Income	\$593,317.41	Total Expenditures	\$387,319.40

*Capital Campaign funds are being used for improvements. See previous page for an update on the use of these funds.

The Schmedding Farm

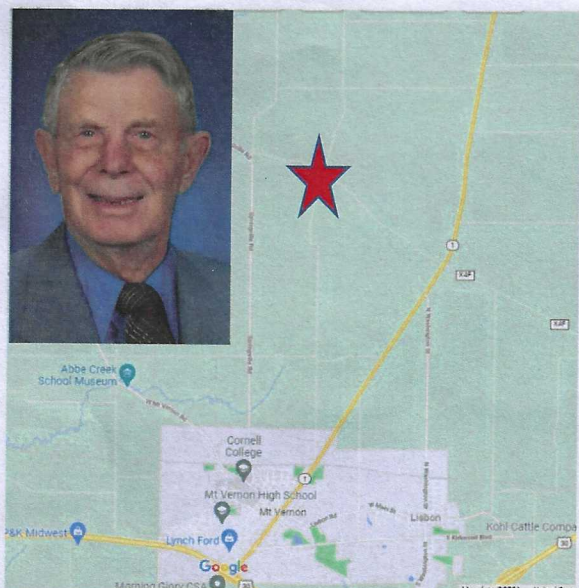

Ray Schmedding and his older brother, Maurice, bought farmland north and west of Mount Vernon, IA in 1971. The two brothers farmed together until Maurice's death in March of 1990. Ray continued to farm until his retirement.

Ray lived a very quiet, humble, and simple life. He was generous with his participation in parish life and worship. Ray was also a generous financial supporter of the parish. Having no family of his own, Ray always believed that the people of St. John were his family.

Just prior to his death in 2011, Ray gave approximately 200 acres of his farm to St. John the Baptist parish.

Under the guidance of the Archdiocese, the pastoral and financial counsels retained the land for the long-term financial benefit of the parish.

The yearly harvest from the land provides St. John with approximately, \$50,000 per year in revenue. The parish pays the property taxes and is responsible for any updates on the farm. We lease the land to a local farmer who provides the work of planting, cultivating and harvesting.

Ray's generous gift continues to help St. John be a strong and vibrant presence in the Lisbon and Mount Vernon area. His gift provides us all with an extraordinary example of authentic *Stewardship*.